

When installing Builddeck Heritage, Vintage or Classic - **400mm** gap between joist centres.
When installing Victoria - **300mm** gap between joist centres (See relevant installation guide)

30mm gap between joists supporting abutted boards.

When installing **72mm** joist - **1200mm** gap between support centres.
When installing **38mm** joist - **600mm** gap between support centres.

For drainage, sub frame height must fall **12.5mm** for every **1000mm** length.

Connect main joists to the perimeter using angled (L-Shaped) joist connectors.

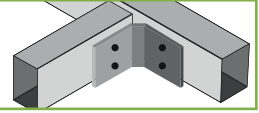

Always leave a **4mm** expansion gap between all joists.

Insert **400mm** spacer profiles where required, to ensure joists are adequately spaced.
Connect using angles (L-Shaped) joist connectors.

Connect main joist lengths together end-on-end using a straight joist connector (leaving a **4mm** expansion gap)

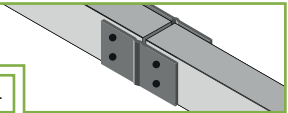

All joins must be set upon and connected to a joist support.

Connect the substructure securely onto joist supports ensuring all is set to the required level as well as allowing for adequate drainage.

Connect perimeter joists using angled (L-Shaped) joist connectors internally.

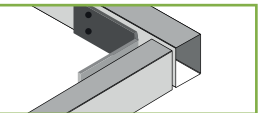

Install decking in accordance to relevant installation guide.

Connect vertical profiles to support the perimeter joists using straight joist connectors.

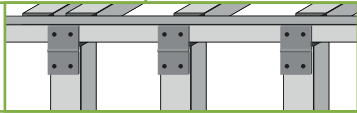

IMPORTANT - Always leave a **4mm** expansion gap between all connecting joists.

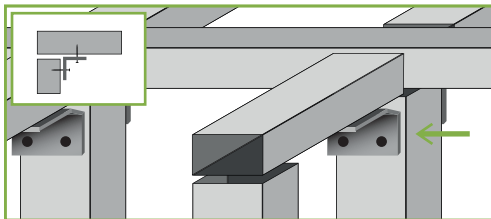
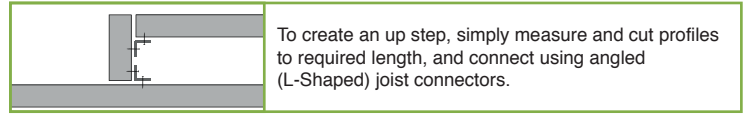
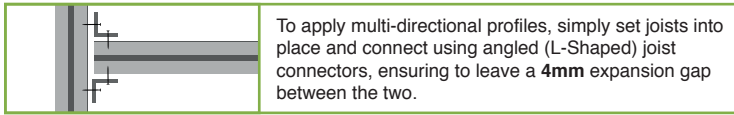
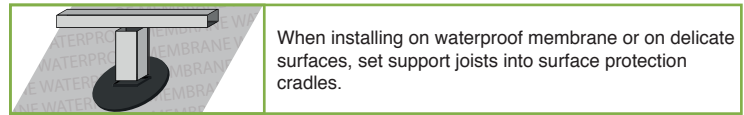
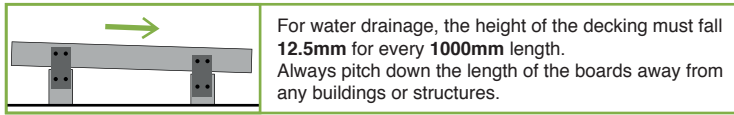
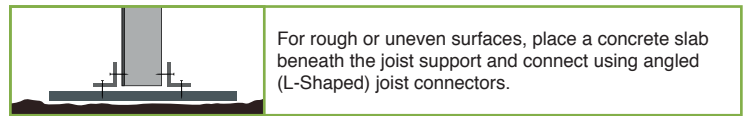
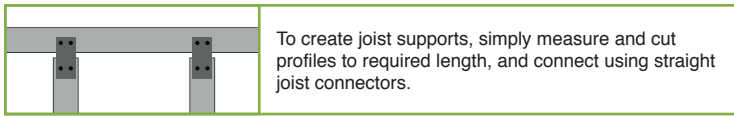

To create steps, cut profiles to required lengths, and connect to down turn supports (fixed to perimeter joist) using angled (L-Shaped) joist connectors.

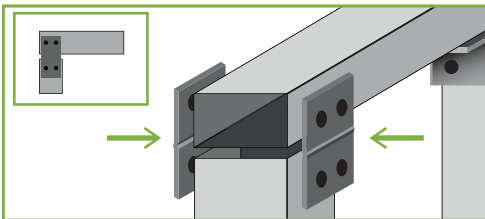

To create down turn for steps, cut profiles to required lengths, and connect using L-Shaped brackets.

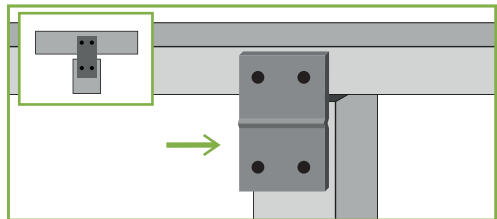

If down turns are required, cut vertical profiles to required length, and connect to perimeter joist using straight joist connectors.

To finish the corners with 45° angles, set the joists according to figure 1 above. Joists **1** and **2** should be set to the full width of the board final board along the edge. Joist **3** should be positioned at the start of the main boards length, taking into account required expansion gaps (see relevant decking installation guide) and must not allow an over hang of more than **20mm**. From joist **3** continue gaps as per relevant decking installation guide.

Figure 1

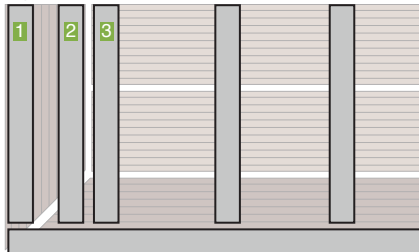
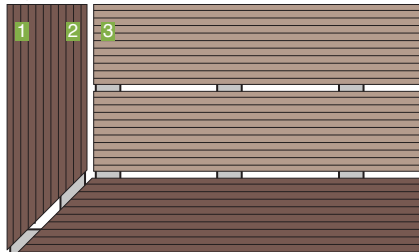

Figure 2



For decking installed at 45° in entirety, the maximum gap between joists should be set at **250mm** centre to centre.

